

## Critical Risk: Potential for Unattended Trucks to Roll Away

Date: March 2019

### 1.0 Introduction

The potential for an unattended truck to roll away in an out of control manner is a critical risk.

The following controls are to be put in place to manage this risk. Some more general risks relating to hired plant and subcontractor operated plant are also addressed.

This Red Alert supersedes the email issued on 15 March 2019 which suspended the use of Nissan Truck models; CG380, CG400, CK330, CM180, CW330, CW380, CW400, manufactured between 1993 & 2005.

### 2.0 Mandatory Requirements

#### 2.1 Nissan Trucks

Nissan Truck models; CG380, CG400, CK330, CM180, CW330, CW380, CW400, manufactured between 1993 & 2005 are not permitted on any Fulton Hogan sites. And, in addition, these trucks are not to be operated by Fulton Hogan employees on any other sites. These mandatory requirements apply unless these trucks have been fitted with a replacement, approved, aftermarket hand brake that complies with the Heavy Vehicle Brake Rule 32015. (Graham Eaton can provide more detail on this if required).

It is strongly recommended that customers who use these trucks to pick up materials from our quarries also make these modifications. In light of this they should each be given a copy of this alert and the May 2017 NZTA safety alert attached. **Unless the improvements described above have been made, quarry customers operating these trucks must not be permitted to leave the cab of their vehicle while at the quarry.**

These modifications to the factory fitted handbrake are necessary because once wear occurs the lock pin is able to hold the brakes on but may not actually be fully engaged. Consequently, the hand brake can be unintentionally released via a knock or vibration.

#### 2.2 Minimum Requirements for Subcontractor Plant and Hired in Plant

From 1 July 2019 all subcontracted and hired in plant must comply with the minimum requirements listed in the table below.

Plant that meets these minimum requirements is to be approved for use by a qualified mechanic or a competent FH Manager, signed off and 'stickered' accordingly. Stickers are available through FH Signs & Graphics and a copy of the order form is attached. Inspection records must be kept by the approving mechanic or manager.

Certification will be valid for 12 months.

The procurement team will work with our preferred plant hire providers to implement this with them.

The Health & Safety team will work with our tier 1 contacts at; Downer, Higgins, CPB, McConnel Dowell, HEB, and Fletchers and, where we have agreement, will look to implement a joint approach to this certification.

It's acknowledged that this manual system may be able to be improved further through the use of technology. Options will be investigated as time and resources permit.



## Critical Risk: Potential for Unattended Trucks to Roll Away

Date: March 2019

Minimum Requirements	Cars & Utes	Trucks	Excavators	Cranes	Other Mobile Plant
<b>Legal Requirements</b>					
Registration	✓	✓	✓	✓	✓
RUCs	✓	✓		✓	
WOF	✓				
COF		✓		✓	✓
Current Crane Certification				✓	
<b>FH Requirements</b>					
Removable towbar bolted	✓				
Reversing alarm		✓	✓	✓	✓
Flashing Light		✓	✓	✓	✓
Seatbelts fitted	✓	✓	✓	✓	✓
Park brake alarms		✓			
Swinging tail door locked out		✓			
Antiburst valves fitted			✓	✓	
ROPs / FOPs / TOPs fitted			✓	✓	✓
Two stage quick hitch (or pinned)			✓		
Certified lifting point			✓		Loaders
Certified lifting chains & strops		✓	✓	✓	✓
First Aid kit	✓	✓			
Fire Extinguisher	✓	✓	✓	✓	✓
Vehicle Prestart Check (Daily)		✓	✓	✓	✓
<b>Air Compressors:</b> Must be fitted with securing straps or double-eye, stocking-style, whip-socks to prevent the hose / pipe from flailing if it uncouples					
<b>Nissan Truck models:</b> CG380, CG400, CK330, CM180, CW330, CW380, CW400, manufactured between 1993 & 2005 are not permitted on FH sites unless these trucks have been fitted with a replacement, approved, aftermarket hand brake that complies with the Heavy Vehicle Brake Rule 32015.					

Minimum Requirements for Hired in and Subcontracted Plant

### 2.3 Safe Parking

#### Resources

There are two parking related videos on the KnowHow Moving Plant channel. (1) Light Trucks – Parking Safely, and (2) Parking or Leaving Heavy Wheeled Plant on Site. Please consider playing and discussing these with all operational staff during your April tailgate meetings.

### 3.0 Additional Notes

- a) It's acknowledged that the implementation of these controls will require conscientious management, time and resources.
- b) Relevant, historical, Red Alert requirements will be included and kept up to date in the new Living Safety Health & Safety Manual due for publication in July.

Thank you for your help with the implementation of these requirements.

**Critical Risk: Potential for Unattended Trucks to Roll Away**

Date: March 2019



**HEAVY VEHICLE SERVICING**

INFORMATION

May 2017

**SAFETY ALERT**  
**AVOID PARK BRAKE FAILURES**

Park brake control valve maintenance and operational requirements for Nissan CK330, CW330, CW380, CW400, CG380, CW400 and CG400 vehicles manufactured between 1993-2005.

The *Nissan Diesel Owner's Manual* recommends that the **park brake hand control valve is overhauled at 12-month intervals**.

It also recommends that the valve's operation is thoroughly checked by a qualified diesel technician when the vehicle is being serviced or if there is concern about its operation.

As some of these vehicles have been in service for some time (up to 24 years old as of 2017), it is important to test the operation of these valves more frequently. Because of the exposure to everyday working conditions and numerous applications this valve can make during a normal working day **it should also be part of the drivers daily pre-start checks**.

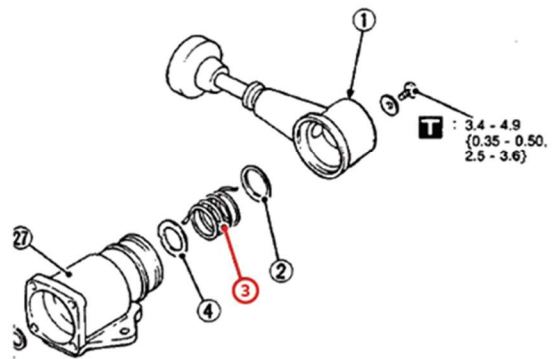

Figure 1. Handle lift to release (spring loaded to lock down)

**Points of note when testing the hand control operation**

- When rotating the hand control handle it should move freely and should be spring loaded to the OFF position (Figure 1, item 3: rotational spring)
- The release handle lock must move freely up and be spring loaded down to the lock position
- With the hand brake applied and in locked position it should not be able to be released (rotated) without lifting the release handle.

**If there are faults found with the above checks the valve must be inspected/replaced before the vehicle is put into service.**

The areas that require a close inspection if you are looking to repair this valve are in the illustrations below (new valve shown).



Locking peg hole

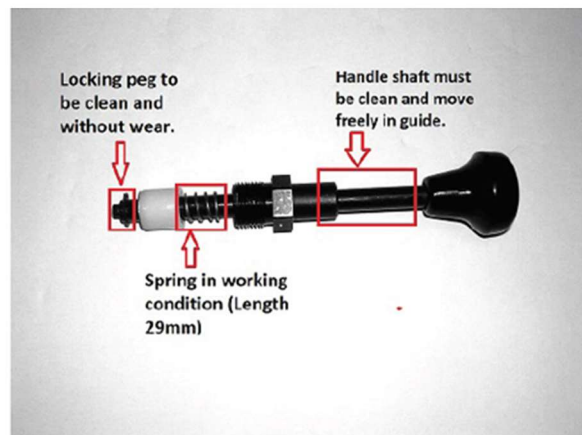

Locking handle removed